

FIELD INSTRUCTIONS

2017-05

FORM: F279563A

Use above FORM number when ordering extra manuals.

For Installing Auto Continuum™ User Interface Kit 301468

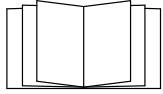

Have only trained and qualified persons install, operate, or service this unit. Call your distributor or the equipment manufacturer if you do not understand the directions. For **WELDING SAFETY** and **EMF** information, read *Owner's Manual*.

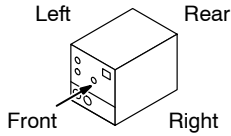

All directions are given as facing front panel.
Keep hardware for reuse.

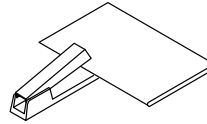

Staple these instructions inside *Owner's Manual*.

1. Safety Symbol Definitions

	<p>DANGER! – Indicates a hazardous situation which, if not avoided, will result in death or serious injury. The possible hazards are shown in the adjoining symbols or explained in the text.</p> <p style="text-align: right;"><small>Fsafe1 2013-10</small></p>		<p>Static electricity can damage parts on circuit boards. Put on grounded wrist strap before touching board.</p> <p style="text-align: right;"><small>Fsafe21 2013-10</small></p>
	<p>Indicates a hazardous situation which, if not avoided, could result in death or serious injury. The possible hazards are shown in the adjoining symbols or explained in the text.</p> <p style="text-align: right;"><small>Fsafe2 2013-10</small></p>		<p>Wear safety glasses with side shields.</p> <p style="text-align: right;"><small>Fsafe8 2013-10</small></p>
<p>NOTICE</p>	<p>Indicates statements not related to personal injury.</p> <p>Indicates special instructions.</p> <p style="text-align: right;"><small>Fsafe3 2013-10</small></p>		<p>CALIFORNIA PROPOSITION 65 WARNINGS</p> <p>Welding or cutting equipment produces fumes or gases which contain chemicals known to the State of California to cause birth defects and, in some cases, cancer. (California Health & Safety Code Section 25249.5 et seq.)</p> <p>This product contains chemicals, including lead, known to the state of California to cause cancer, birth defects, or other reproductive harm. <i>Wash hands after use.</i></p> <p style="text-align: right;"><small>Fsafe4 2013-10</small></p>
	<p>Beware of electric shock from wiring. Disconnect input power before installing this kit. Reinstall all panels and covers.</p> <p style="text-align: right;"><small>Fsafe7 2013-10</small></p>		

2. Tools Needed

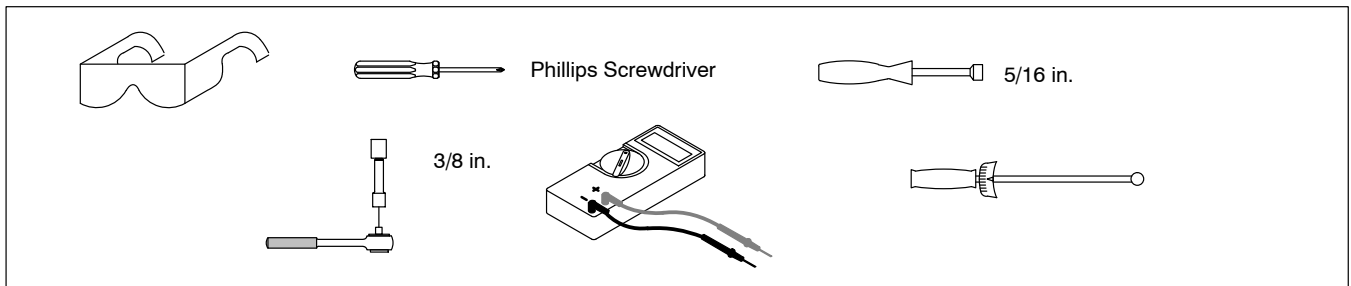

3. User Interface Panel Removal And Plate Installation

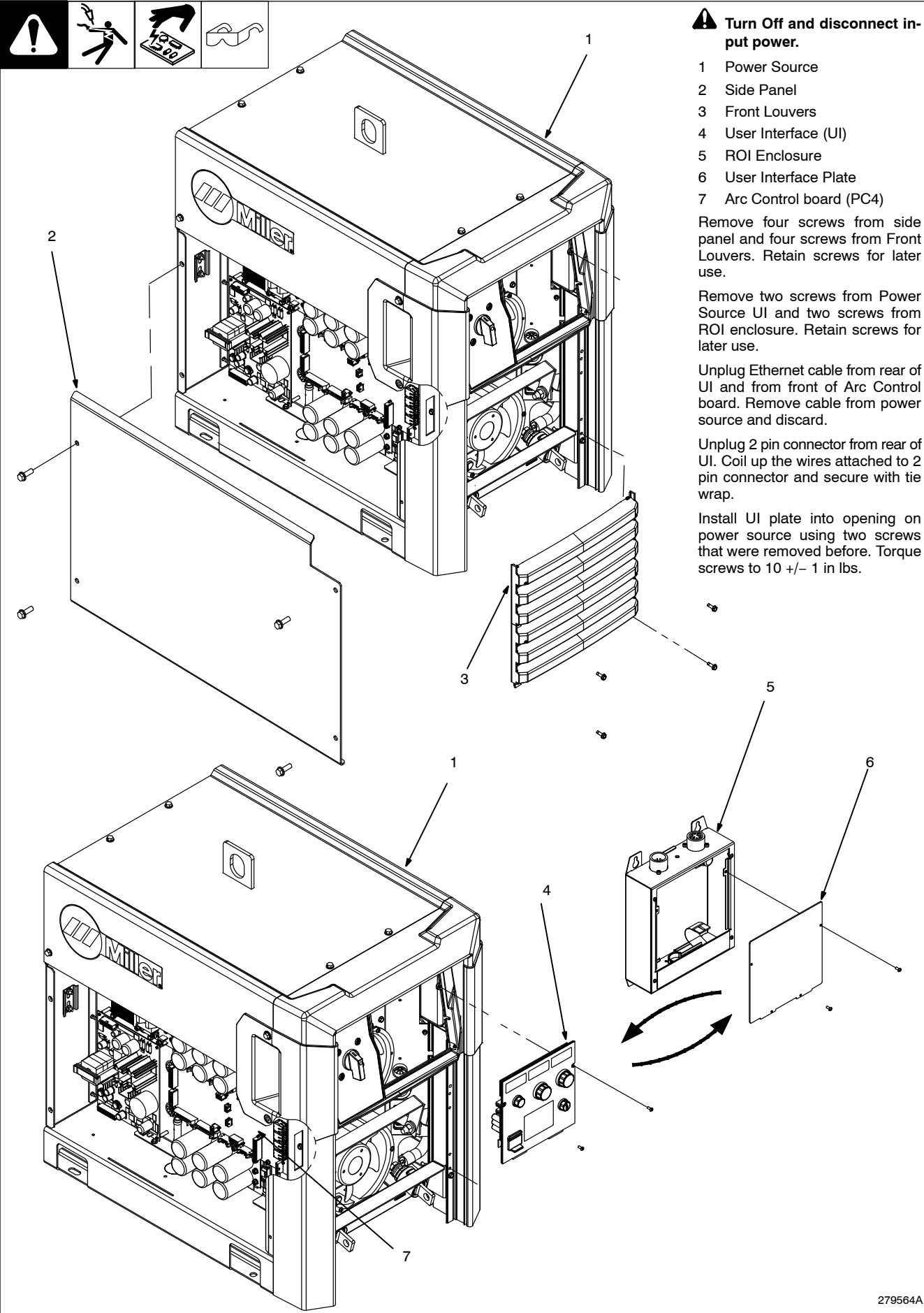

⚠ Turn Off and disconnect input power.

- 1 Power Source
- 2 Side Panel
- 3 Front Louvers
- 4 User Interface (UI)
- 5 ROI Enclosure
- 6 User Interface Plate
- 7 Arc Control board (PC4)

Remove four screws from side panel and four screws from Front Louvers. Retain screws for later use.

Remove two screws from Power Source UI and two screws from ROI enclosure. Retain screws for later use.

Unplug Ethernet cable from rear of UI and from front of Arc Control board. Remove cable from power source and discard.

Unplug 2 pin connector from rear of UI. Coil up the wires attached to 2 pin connector and secure with tie wrap.

Install UI plate into opening on power source using two screws that were removed before. Torque screws to 10 +/- 1 in lbs.

4. Installing User Interface into ROI Enclosure



Connect to Power Source

Connect to Wire Feeder

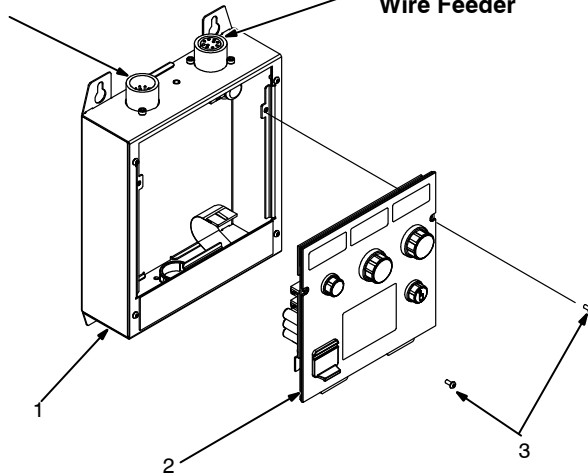

- 1 ROI Enclosure
- 2 User Interface (UI)
- 3 Screw, 006-32 x .312 Pan Head

Connect Ethernet cable from ROI Filter board (PC45) to RC6 located on back of User Interface (Item 2)

Connect Ethernet cable from ROI Filter board (PC46) to RC2 located on back of User Interface (Item 2)

Connect 2 pin connector from ROI Feeder board (PC45) to RC1 located on back of User Interface (Item 2)

Connect 10 pin ribbon cable from ROI switch membrane to RC12 located on back of User Interface (Item 2)

Install the User Interface (Item 2) in ROI Enclosure (Item 1) using two screws (Item 3) that were removed from previous section. Torque screws to 10+/-1 in lbs.

Connect external cables.

Ref. 279564A

User Interface

5. Parts List

Item No.	Dia. Mkgs.	Part No.	Description	Quantity
301468 Kit, Auto Continuum User Interface Installation				
...	1	266071	Plate, UI Blank	1
...	2	267033	Membrane, Switch Control Continuum ROI	1
...	3	271079	Cable, Ethernet Cat6 FTP RJ45 12.000 In Lg	2
...	4	262437	Circuit Card Assy, Feeder 10 Pin Filter	1
...	5	261868	Circuit Card Assy, Power Source 10 Pin Filter	1
...	6	605510	Cable Tie, 0-.750 Bundle SST 1	1

BE SURE TO PROVIDE MODEL AND SERIAL NUMBER WHEN ORDERING REPLACEMENT PARTS.